

Bachelor of Science in Art Education Specific Portfolio Requirements for Admissions and Scholarship Consideration

BS in Art Education Freshman Applicants

The interview and portfolio review is a private session with a Tyler faculty member or a member of the admissions staff. At this time you will present and discuss your portfolio of artwork. Members of the Admissions staff will be available to answer your questions before or after your interview. You may also arrange to have a tour of the facilities either before or after your review. Please call the Tyler Admissions office to set up a portfolio review appointment. Students who live at a distance may elect to upload the portfolio, drawing exercise and writing exercise to our website: www.temple.slideroom.com. Do not send CD-ROMs, DVDs, slides, slide carousels, portfolios, photographs, binders or original work through the mail. These are not acceptable and will not be reviewed or returned.

All students interested in applying for portfolio scholarships must complete the self-portrait requirement (please refer to Scholarship requirements as outlined in additional detail below). Applicants are responsible for ensuring that the necessary application materials are received (not postmarked) in the appropriate offices by the deadline specified on the 2010-2011 Fact Sheet.

BS in Art Education Freshman Portfolio

The portfolio should contain the following:

1. **At least 5 examples of self-selected creative work.** This work should clearly demonstrate your creative capacities in a variety of media. Assessment of this work will be based on the following:
 - Is there evidence of observational capacity in the work submitted? This means that at least two of the pieces should be drawn from direct observation (not from photographic references).
 - Is the work creative?
 - Is there evidence of craft, care and technical competence in the work submitted?

In addition to the above, applicants are required to submit the following:

2. **A Drawing Exercise.** Produce a **graphic representation** in response to the following quote:

" . . . It was the hidden side of everything that intrigued me, the hidden side of gardens, the hidden side of streets, the hidden side of towns, the hidden side of televisions, the hidden side of dishwashers, . . . But when I managed to get to the hidden side, I realized that what I was looking for was the hidden side of the hidden side, or rather, the hidden side of the hidden side . . . "
from Italo Calvino, "The Mirror, the Target," in *Numbers in the Dark*, trans. Tim Parks (New York: Pantheon, 1995)
http://www.ruanyifeng.com/calvino/2008/12/the_mirror_the_target_en.html

This is an artistic exercise and there is no correct or incorrect answer. Your work may be in any medium and must be brought to your portfolio review or be included as part of your SlideRoom portfolio if you are submitting your portfolio on-line. Assessment will be based on the following:

- Does the representation communicate something about the quote, such as scale and quality of space, duration and sequence, movement etc.?
- Are the medium and techniques used appropriate, such as layering, cutting, overlapping, unraveling, inferring etc.
- Are the medium and techniques competently used?
- Are the medium and techniques creatively developed?

3. **A Writing Exercise** based on your response to the image on the next page is also required for admission. Carefully look at the image on this page. What does this image convey to you? Using a maximum of 500 words, complete a piece of creative writing that explores your response to the image. There is no correct answer. This document must be brought to the review or uploaded onto www.temple.slideroom.com as part of your total portfolio.

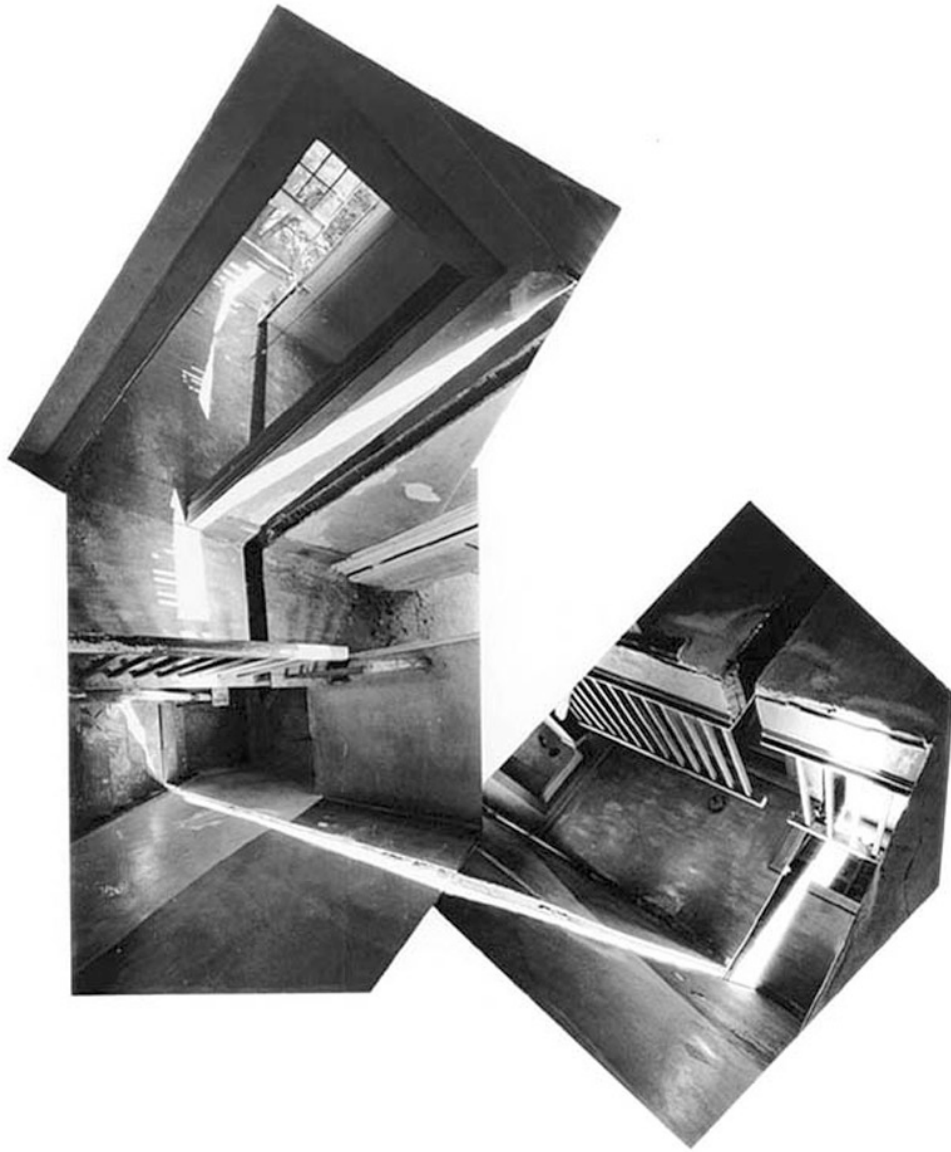

Gordon Matta-Clark, "Splitting," (1974)
www.artnet.com

Assessment will be based on the following criteria:

- Does the writing communicate something about the image, i.e. is it more than merely a description?
- Does the writing frame or interpret the image so that the reader sees it in a new, unexpected way?
- Is the writing creative?
- Is language used competently in the writing (structure, spelling, grammar, punctuation, etc.)?

BS in Art Education Transfer Portfolio

All transfer applicants must upload a portfolio consisting of 10 to 20 images at www.temple.slideroom.com. At least two of the pieces should be drawn from direct observation (not from photographic references). When uploading, follow the instructions on the SlideRoom website. There is an additional \$10 fee to upload to SlideRoom. Make certain to include examples of coursework completed at the college level for both admissions and placement purposes. The Tyler transfer committee will review the work to determine studio placement into the BS in Art Education program. Although an interview is not required for admission, transfer applicants are encouraged to make an appointment to tour the facilities. A description list indicating medium, title, and date completed should be included in the portfolio. A maximum of 24 studio credits will be considered for transfer. Transfer students wishing to compete for portfolio-based scholarships must submit a self-portrait as outlined below. All applicants must also complete the writing exercise listed above in Freshman requirements. Applicants

who have not completed a college level drawing course must submit the drawing exercise (see above Freshman requirements). CD-ROMs, DVDs, slides, slide carousels, portfolios, photographs, binders or original work through the mail. These are not acceptable and will not be reviewed or returned.

Freshmen with Advanced Placement (AP) or College Transfer Credits for all Tyler Programs

Those freshmen who pass the portfolio review and have taken college level studio coursework while in high school must send in official college transcripts as well as a portfolio uploaded to www.temple.slideroom.com (SlideRoom charges a \$10 fee for this service) which represents the coursework taken in order to be considered for transfer credit. Transfer credits received through AP exams or through attendance at an accredited college will be evaluated by the Office of Undergraduate Admissions of Temple University upon receipt of the completed application, official transcripts, and test scores. All AP test scores must be submitted to the Office of Undergraduate Admissions at Temple by requesting that they be sent directly from the College Board at www.collegeboard.com. Students receiving a score of at least a 3 in AP studio examinations will receive 3 studio credits that will be evaluated for elective credit.

Self-portrait

ALL scholarship applicants must execute one drawing specifically for Tyler as an essential part of the scholarship application. The self-portrait should be drawn in pencil, charcoal, or conte crayon (make sure you fix the drawing so that it doesn't smudge), on **8 1/2" by 11"** paper from a mirror reflection. **Do not include a self-portrait that has been copied from a photograph or a scanned image.** This drawing is sent as part of the application with the understanding that it is a permanent part of the application and will not be returned. You must send in the original drawing to the Tyler Admissions office with the label below permanently affixed to the back. The portrait may not be included in the portfolio as it is a separate requirement. The application is not considered complete without the self-portrait. The self-portrait and the statement of purpose or writing exercise are important factors, along with the assessment of the portfolio, in the determination of scholarship nominees. Tyler Admissions is not responsible for self portraits that were not labeled correctly. Please be sure to review scholarship deadlines and complete information on the Tyler website.

Labels

All Scholarship Applicants: Use these labels to identify self-portraits and writing exercises for admission and scholarship purposes. Mail these materials to: *Office of Admissions, Tyler School of Art, 2001 N 13th Street, Philadelphia, PA 19122*

Self Portrait Label (Scholarship Applicants only)

Applicant Name (No Nicknames) _____
Address _____ City _____
State _____ Zip _____ Country _____ email _____ Phone _____
Intended Degree Program _____

Writing Exercise Label

Applicant Name (No Nicknames) _____
Address _____ City _____
State _____ Zip _____ Country _____ email _____ Phone _____
Intended Degree Program _____